

I watch C. span because:

4/10/84

Hummmmm

What can I say? Do I need 500 words to describe why C. span is so respected (yes, even revered) as the one Oasis of true & objective reality in the vast wasteland of P.V. "media"?

Well, well see:

C. span, to me, is the open forum of the average American citizen. When I need to know the true attitudes and reactions (various polls not withstanding) I turn to C. span, where each caller is allowed to freely & fully voice his or her opinions and ask the questions they consider important. Never, never at any time is one made to feel uncomfortable because of biased reaction on C. span's part - because there is no bias - Unbelievable!

But true.

When C. span is criticized by a caller, they do not argue or evade the issue. C. span politely offers their intention to re-examine their position &/or policy & maintain their fair & objective treatment of all issues & people.

Bravo - I know of no other group, private, political or business, in a position of relative power, who will concede in this manner to the average

citizen — least of all, J.V. Medina.

I will close by saying what each & every one of your reviewers say — Thank you C. span —
You light up my life!

Sincerely
Your monthly caller

[REDACTED]

P.S. The light of inspiration struck me after I had opened my shop and, having no paper (decent, that is) I'm using this stuff — Please excuse [REDACTED]

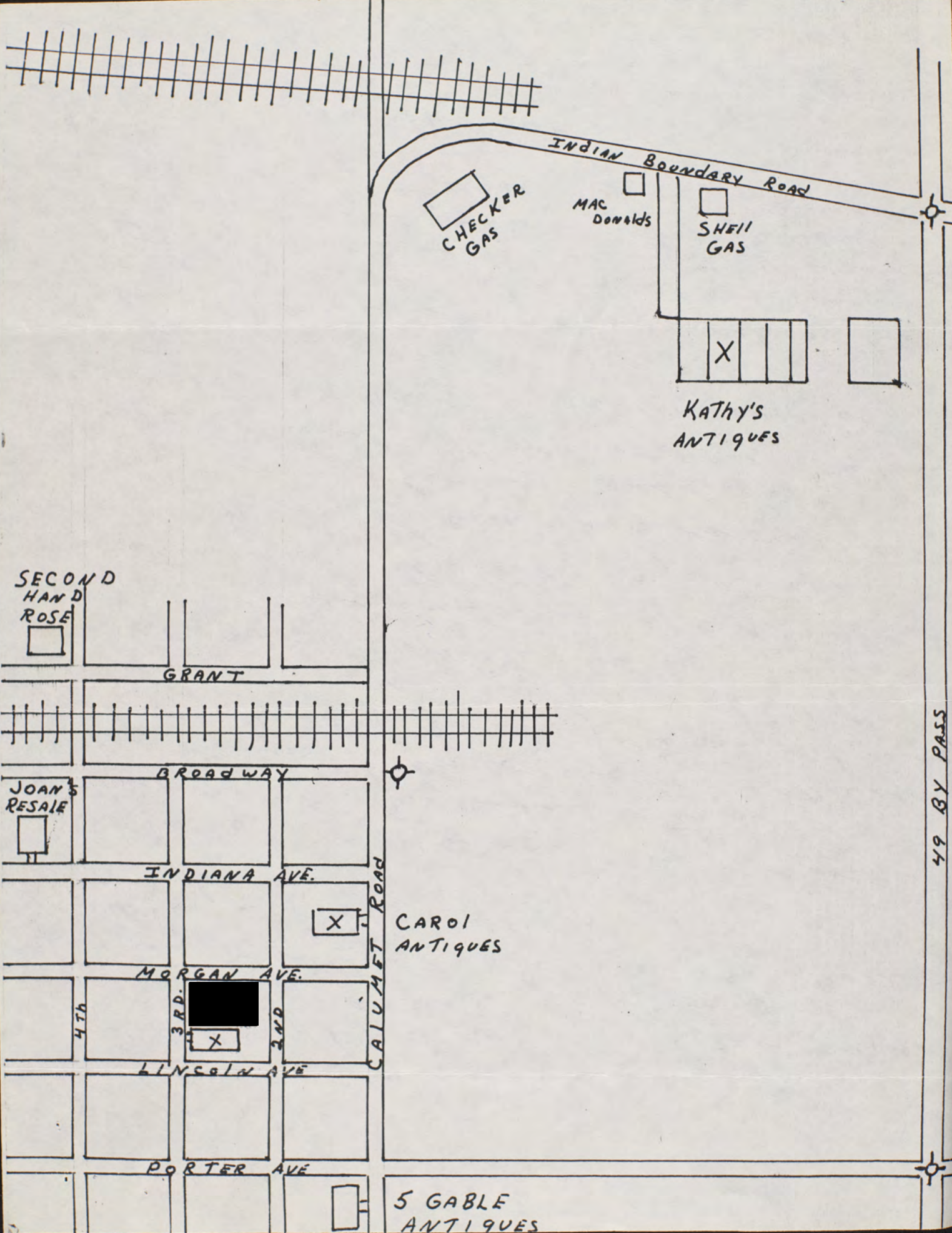

INDIAN BOUNDARY ROAD

CHECKER GAS

MAC DONALDS

SHELL GAS

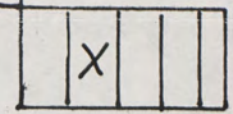

KATHY'S ANTIQUES

SECOND HAND ROSE

GRANT

BROADWAY

JOAN'S RESALE

INDIANA AVE.



CAROL ANTIQUES

MORGAN AVE.

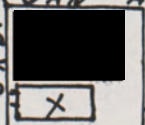

LINCOLN AVE.

PORTER AVE.



5 GABLE ANTIQUES

49 BY PASS

Commercial map

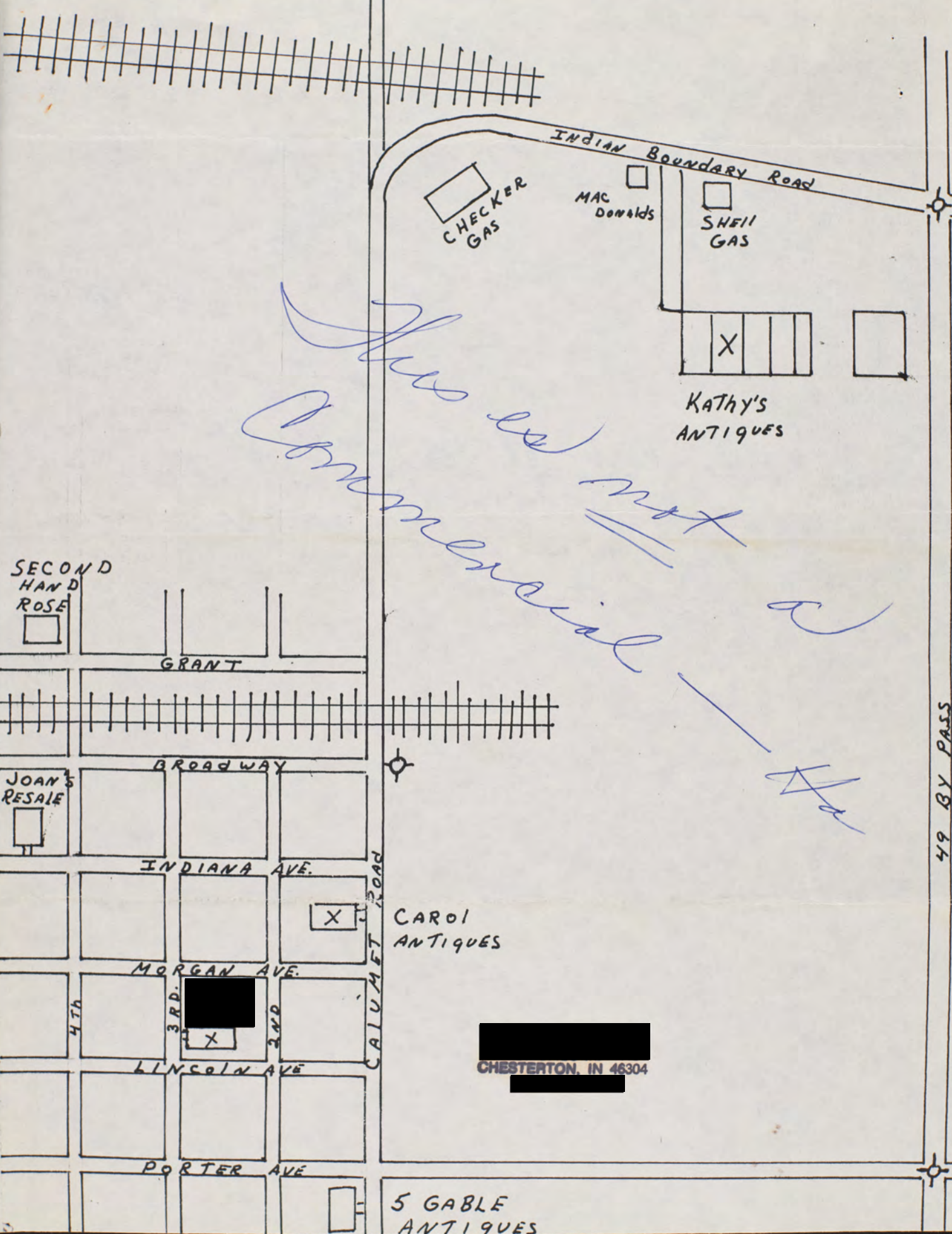

CHECKER GAS

MAC Donalds

SHELL GAS

KATHY'S ANTIQUES

SECOND HAND ROSE

GRANT

BROADWAY

JOAN'S RESALE

INDIANA AVE.

X

CAROL ANTIQUES

MORGAN AVE.

X

CHESTERTON, IN 46304

LINCOLN AVE

PORTER AVE

5 GABLE ANTIQUES

49 BY PASS

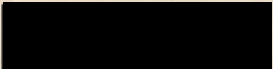
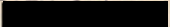
CHESTERTON, IN 46304



*C. Spon
Suite 155
400 N. Capital St.
Washington, D.C.
20001*

Contact entry